

# Alfa Laval PlusClean® UltraPure

## Wall mounted cleaning nozzles

### Introduction

Alfa Laval PlusClean® UltraPure is a wall mounted cleaning nozzle designed for cleaning of shadow areas in tanks; e.g. below agitator blades and other tank internals. Alfa Laval PlusClean® UltraPure is smoothly integrated into the tank wall. When activated during Cleaning-in-Place (CIP), Alfa Laval PlusClean® UltraPure covers cleaning shadow areas with a high impact fan of cleaning media, giving the market's first guarantee of 100% impact cleaning coverage.

### Application

Alfa Laval PlusClean® UltraPure is engineered to meet sterile and aseptic process requirements in the biotechnology and pharmaceutical industries and is thus supplied with the comprehensive Alfa Laval Q-doc documentation package. Alfa Laval PlusClean® UltraPure is the key to ensure high product yield by eliminating any risk of contamination. This is done by targeting cleaning media to the shadow zones for reinforced hygienic tank cleaning. Alfa Laval PlusClean® UltraPure is optimal for installation in all tank types and tank sizes with highest hygienic tank cleaning requirements to ensure high product quality.

### Benefits

- High product yield with 100% cleaning coverage guarantee
- Low cleaning media consumption
- Installed flush with the tank wall, allowing the unit to be used in tanks with frame type agitators
- Easy to install using the patented adjustable flange connection
- Hygienic design
- Option for actuator & ThinkTop control unit
- Full traceability with Q-doc package

### Available versions

- Alfa Laval PlusClean® UltraPure media driven
- Alfa Laval PlusClean® UltraPure air driven by a pneumatic actuator

### Standard design

The Alfa Laval PlusClean® UltraPure is available as standard with all wetted stainless-steel components manufactured from AISI 316L. O-rings are made from EPDM and FPM (FKM); both in compliance with FDA regulation and USP Class VI. The choice of slot (spray pattern) can optimize spray impact length and flow rate at the desired pressure.



### Certificates

- Q-Doc
- ATEX/UKEx/IECEX

Q-doc applicable to product contact parts only.



## Working principle

Alfa Laval PlusClean® UltraPure operates based on a spring activated piston and is available in media or pneumatic driven versions and can thus be activated from either the cleaning media or controlled air pressure. When activated, Alfa Laval PlusClean® UltraPure sprays a high impact fan of cleaning media directly to the soiled area. Cleaning coverage is ensured through controlled and repeated rotation of the device, e.g. agitator blades, through the spray fan. When cleaning is completed the piston position is restored by the integrated spring mechanism and the cleaning device is securely closed and sealed off. If purging is needed, always operate with actuator. Alfa Laval PlusClean UltraPure® operates perfectly together with the primary top mounted cleaning device, whether it is a static spray ball, rotary spray head or a rotary jet head type cleaning device.

## Technical data

### Technical data

Product wetted surface finish:	Ra 0.38 µm / Ra 15 µin Electropolished (ASME BPE SF4)
Wetting distance:	Maximum 7.4 m / 24.3 ft
Impact cleaning distance:	Maximum effective 5.4 m / 17.9 ft

### Pressure

CIP working pressure:	1.9 - 7 bar / 27.6 - 101.5 PSI
Recommended CIP pressure:	2 - 5 bar / 29.0 - 72.5 PSI
Tank pressure range:	Media driven: -1 to 4 barg / -14.5 to 58 PSI Air driven: -1 to 6 barg / -14.5 to 87 PSI

## Spray pattern

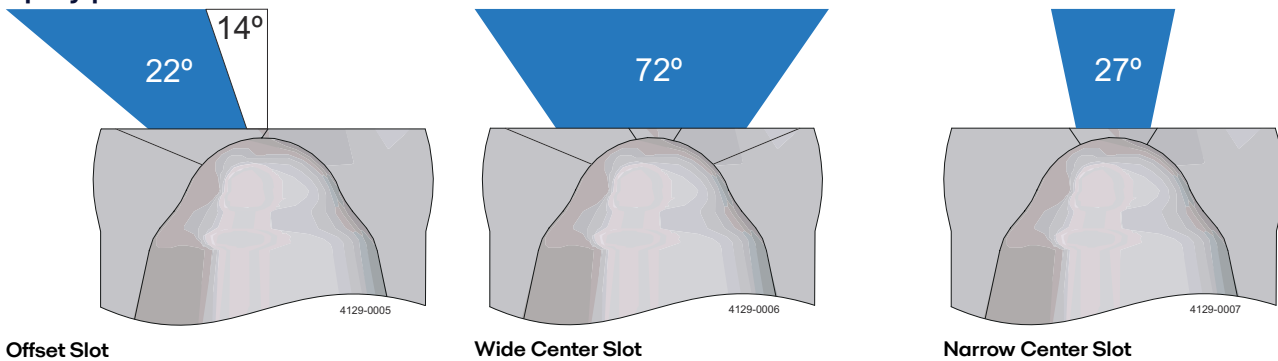

Offset Slot

Wide Center Slot

Narrow Center Slot

## Physical data

### Materials (media contact parts)

Components:	AISI 316L
O-rings:	EPDM, FPM (FKM)
Guide ring:	PTFE

### Temperature

Maximum cleaning fluid temperature:	95 °C / 203 °F
Maximum tank temperature:	150 °C / 302 °F

### Weight

Weight:	Media driven: 2.1 kg / 4.6 lbs Pneumatic driven: 2.7 kg / 6 lbs
---------	--

### Connections

Cleaning media connection:	Clamp connection: ASME BPE - L14AM-0.75 / DIN32676 Reihe A DN15
Air connections for actuator:	ISO 288 / G 1/8" internal thread fitted as standard

## Mounting options

Alfa Laval PlusClean® UltraPure has 2 types of weld plates: Adjustable weld plate and fixed weld plate.

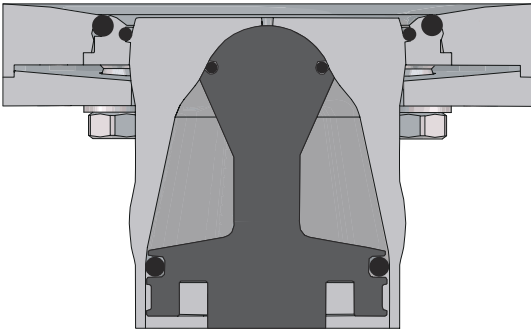

Adjustable weld plate

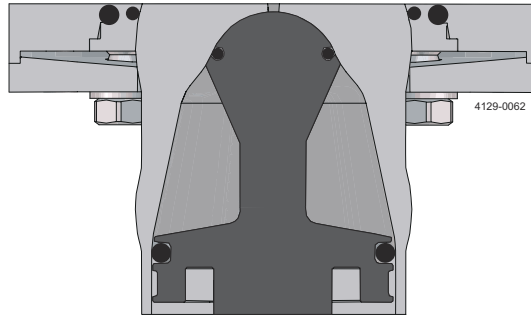

Fixed weld plate

The adjustable weld plate has a curved surface on the tank side of the weld plate and allows adjusting the angle of the cleaning nozzle  $\pm 5^\circ$  from the center along all 3 axes. It is drainable only when installed at an angle more than  $30^\circ$ . The adjustable weld plate should be used in applications where the Alfa Laval PlusClean® UltraPure is installed on tank walls and tank bottoms with more than  $30^\circ$  inclination to horizontal.

The fixed weld plate only allows the device to rotate around Z-axis. It is drainable at all angles due to the flat top surface.

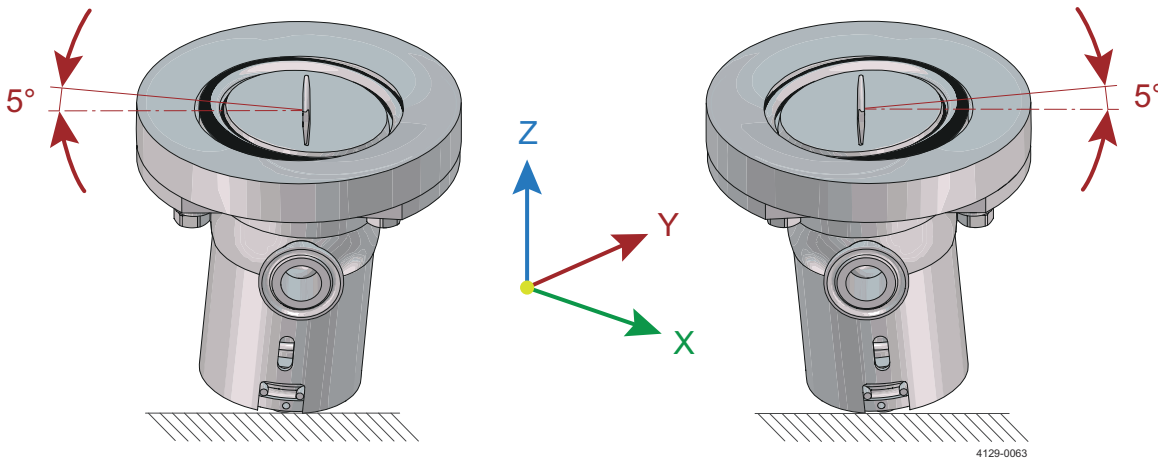

### Performance data

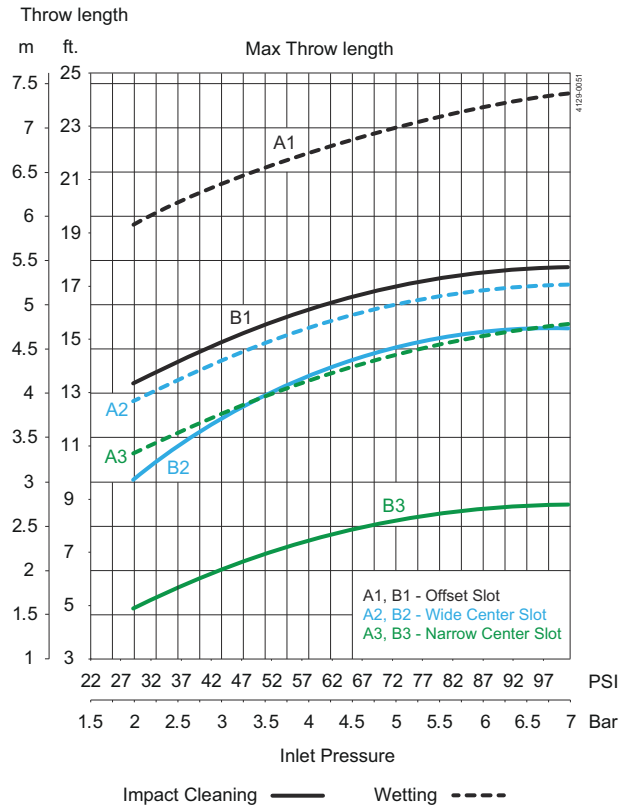
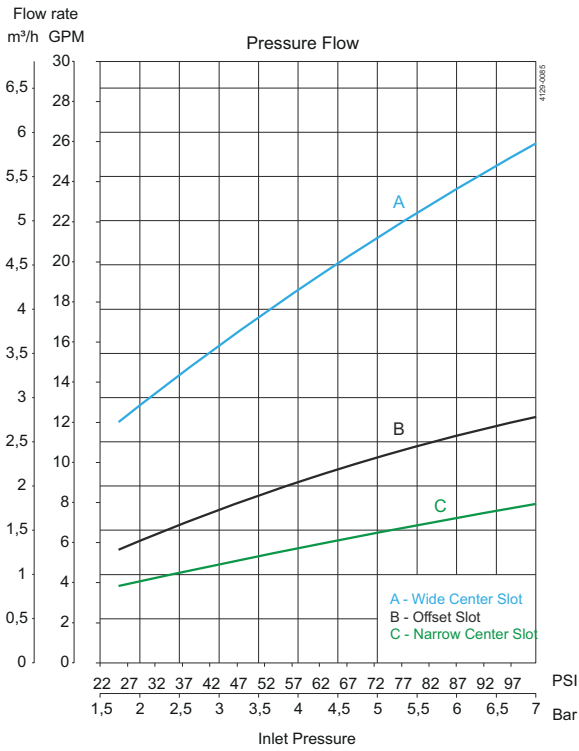

### Qualification documentation

#### Documentation specification

ATEX/UKEx/ IECEX	ATEX/UKEx/IECEX approved machine for use in explosive atmospheres INSIDE MACHINE: Category 1 for installation in zone 0/20 OUTSIDE MACHINE: Safe area only II 1G/- Ex h IIC 85°C...188°C Ga/- II 1D/- Ex h IIC T85°C...T140°C Da/-
Q-doc	Equipment Documentation includes: <ul style="list-style-type: none"> <li>• EN 1935/2004 DoC</li> <li>• EN 10204 type 3.1 inspection Certificate and DoC</li> <li>• FDA DoC</li> <li>• GMP EC 2023/2006 DoC</li> <li>• EU 10/2011 DoC</li> <li>• ADI DoC</li> <li>• QC DoC</li> <li>• USP 87 and 88 Class VI or ISO 10993-5 and ISO 10993-6, -10, -11 DoC (for UltraPure products)</li> </ul>

### Dimensions

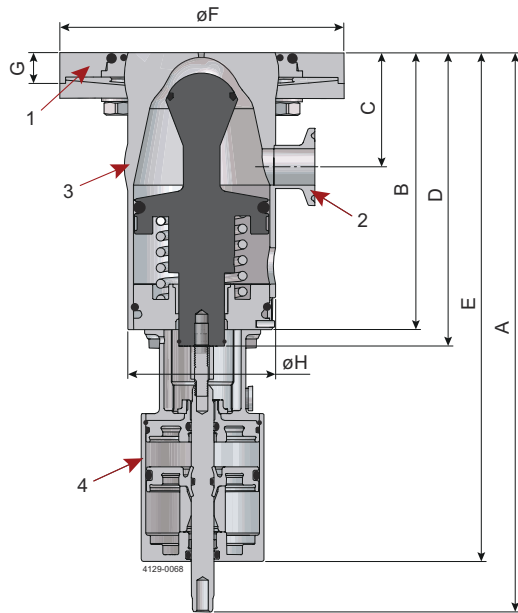

1. Tank connection
2. Inlet connection for cleaning media: 3/4" Clamp
3. Alfa Laval PlusClean® UltraPure
4. Pneumatic Actuator

A-H see tables below

#### Media driven

mm / inch

Stroke	A	B	C	D	E	F	G		H	Weight
							Adjustable weld plate	Fixed weld plate		
10.9 / 0.4	NA	122 / 4.8	50.5 / 2.0	132 / 5.2	NA	130 / 5.1	18 / 0.7	15 / 0.6	65 / 2.6	2.1 kg / 4.6 lbs

#### Pneumatic driven

mm / inch

Stroke	A	B	C	D	E	F	G		H	Weight
							Adjustable weld plate	Fixed weld plate		
10.9 / 0.4	246.5 / 9.7	122 / 4.8	50.5 / 2.0	132 / 5.2	224 / 8.8	130 / 5.1	18 / 0.7	15 / 0.6	65 / 2.6	2.7 kg / 6.0 lbs

This document and its contents are subject to copyrights and other intellectual property rights owned by Alfa Laval AB (publ) or any of its affiliates (jointly "Alfa Laval"). No part of this document may be copied, re-produced or transmitted in any form or by any means, or for any purpose, without Alfa Laval's prior express written permission. Information and services provided in this document are made as a benefit and service to the user, and no representations or warranties are made about the accuracy or suitability of this information and these services for any purpose. All rights are reserved.

#### How to contact Alfa Laval

Up-to-date Alfa Laval contact details for all countries are always available on our website at [www.alfalaval.com](http://www.alfalaval.com)